

FOR LEASE

Orlando, FL CAPITOL PLAZA II SUBLEASE

301 E PINE ST, STE 650 • ORLANDO, FL • 32801

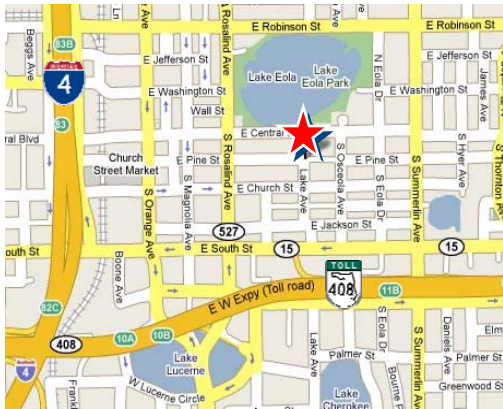

AVAILABLE GROSS SUITE AREA

Suite 650: 7,034± SF

THE PROPERTY

- One of Downtown Orlando's Premier Office addresses
- Sublease terminates February 28, 2011
- Unique suite features
- Tremendous views looking over Lake Eola
- 3/1000 Parking Ratio
- Site offers many amenities including Class "A" finishes throughout the building and on-site 24 hour security.

LOCATION

Direct I-4 and East/West Expressway access

LEASE RATE

\$15.00 / Full Service

Jamie Barati, CCIM
407.362.6163
jbarati@colliersarnold.com

Todd Davis, CCIM
407.362.6121
tdavis@colliersarnold.com

COLLIERS ARNOLD
622 E. Washington St.
Suite 300
Orlando, FL 32801
Phone: 407.843.1723
Fax: 407.843.4485
www.colliersarnold.com

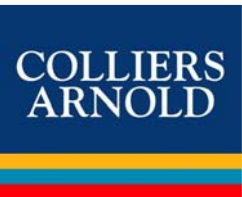

Orlando, FL CAPITOL PLAZA II SUBLEASE

301 E PINE ST, STE 650 • ORLANDO, FL • 32801

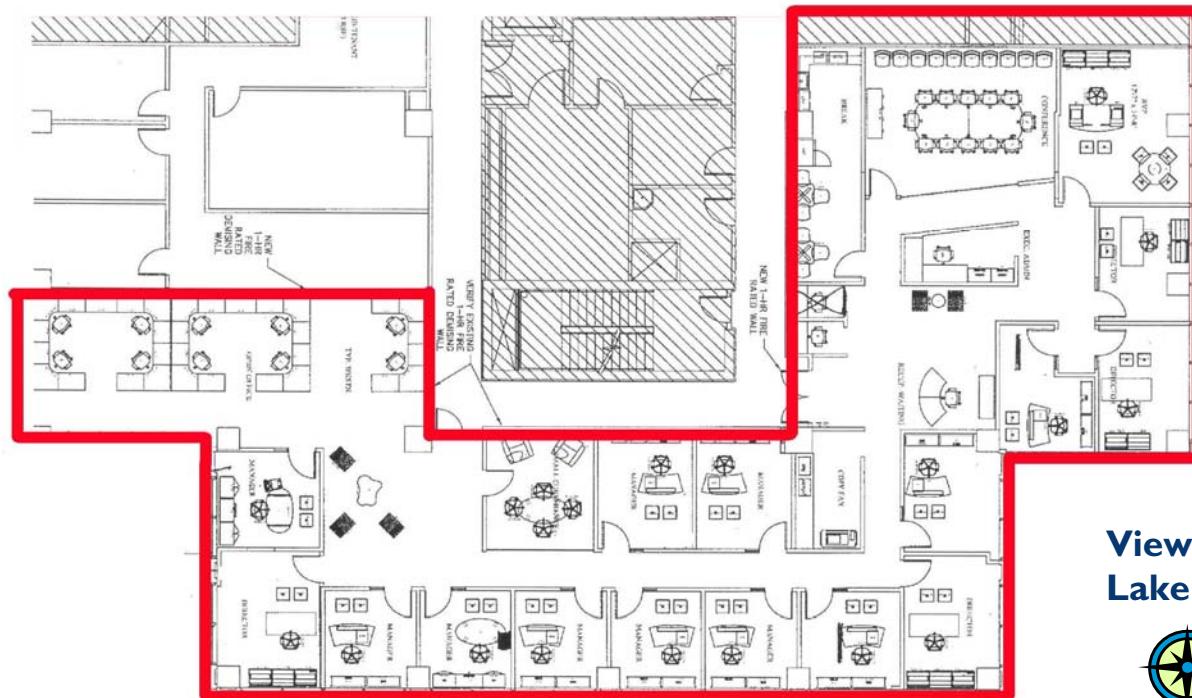

Views of
Lake Eola



7,034 RSF



This document has been prepared by Colliers Arnold for advertising and general information only. Colliers Arnold makes no guarantees, representations or warranties of any kind, expressed or implied, regarding the information including, but not limited to, warranties of content, accuracy and reliability. Any interested party should undertake their own inquiries as to the accuracy of the information. Colliers Arnold excludes unequivocally all inferred or implied terms, conditions and warranties arising out of this document and excludes all liability for loss and damages arising there from.

Colliers International is a worldwide affiliation of independently owned and operated companies.

