

TIDEWATER VILLAGE IN FALMOUTH

UP TO 9,570 ± SF FOR LEASE OR SALE



Tidewater Village is a high quality mixed-use development creating a new neighborhood connecting Clearwater Drive to the Presumpscot River Basin and Casco Bay.

Located off Route 1 in Falmouth at the southern end of Tidewater Village, this 3½ story complex at 75 Clearwater Drive offers up to 9,570± SF of retail and office for lease or for sale on its first and second floors. Luxury townhouse residences are on its upper floors.

For further information contact:

Joe Malone, CCIM
(207) 772-2422
joe@malonecb.com



PROPERTY SUMMARY

LOCATION:	75 Clearwater Drive Falmouth, Maine
OWNER:	Emery Waterhouse
LANDLORD:	Clearwater II LLC
ZONE:	Tidewater Master Planned Development District
AVAILABLE SQ FOOTAGE:	9,570± total available <ul style="list-style-type: none">• 3,410± SF - First Floor #104 (Subdividable)• 1,656± SF - Second Floor #204• 802± SF—Second Floor #204B• 3,701± SF - Second Floor #206
AVAILABILITY:	Now
USE:	Retail and/or office
UTILITIES:	Public water and sewer
LEASE RATE:	\$18.00 PSF Triple Net (NNN) Landlord will provide \$28 PSF fit-up allowance
NNN EXPENSES:	\$4.41 ¹ PSF - First Floor \$4.79 ^{1,2} PSF - Second Floor <i>¹ Real estate taxes are estimated due to new construction</i> <i>² Second floor expenses include elevator maintenance</i> <i>Expense breakdown available upon request</i>
SALE PRICE:	\$222. PSF (includes \$28 PSF fit-up allowance)
BROKER:	Joe Malone, CCIM (207) 772-2422 joe@malonecb.com

Tidewater Master Planned Development District

This district is intended to allow development of the Tidewater area into a high quality, mixed use commercial/residential neighborhood while preserving a significant portion of the area as open space including much of the historic Tidewater Farm.

The standards and procedures of the district are designed to permit maximum creativity in site design and ensure high quality construction with special attention to landscaping, lighting, building orientation and form, coordination of architecture, and signage.

Permitted uses include: business and professional offices, retail and service establishments, health institutions, day care centers.

The Falmouth Zoning Ordinance can viewed online at: <http://www.town.falmouth.me.us/Pages/search>

Malone Commercial Brokers, Inc., is representing the Seller in the marketing, negotiation, and sale and/or lease of this property. While information furnished is from sources deemed reliable, no warranty or representation, express or implied, is made as to the accuracy of information contained herein, and same is submitted subject to errors, omissions, change of price, rental or other conditions, withdrawal without notice, and to any special listing conditions imposed by our principals. [Ver 2009:5]



FIRST FLOOR

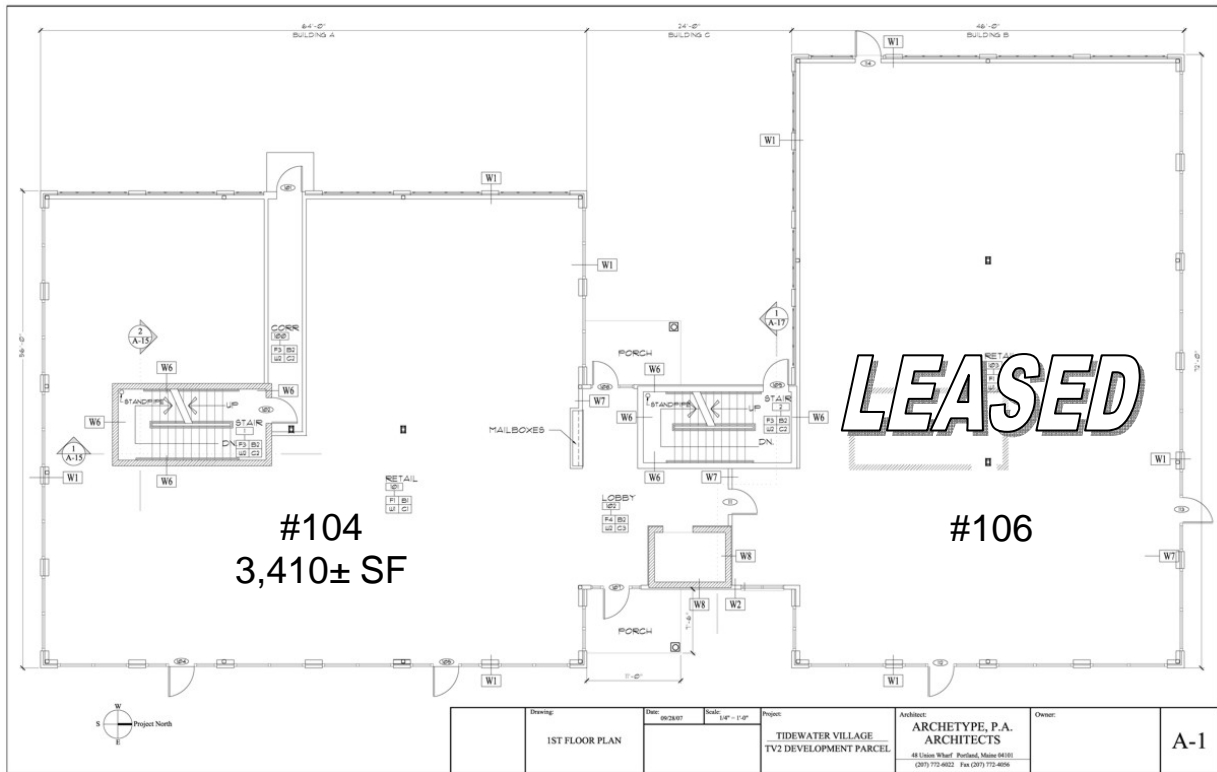

SECOND FLOOR

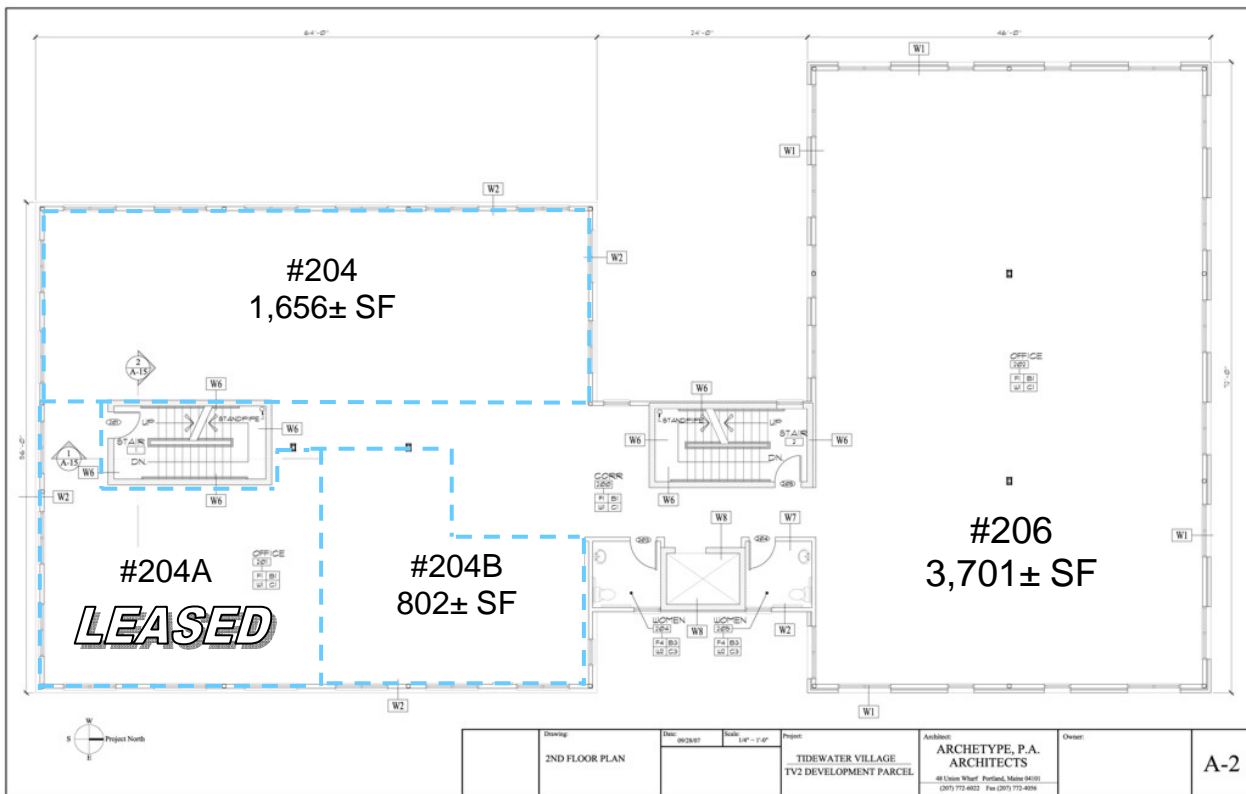

Spaces are provided in as a clean vanilla shell. \$28/PSF fit-up allowance for tenants. Fit-up allowance of \$28 PSF is included in the sale price.

GENERAL AREA

Tidewater Village is conveniently accessible and close to major roads.

	DISTANCE
I-295	1± mile
I-95/Turnpike	1.3± miles
Portland	3± miles
Route 9	1.2± miles
Route 88	1± mile



Malone Commercial Brokers, Inc.

5 Moulton Street
Portland, Maine 04101

Broker:

Joe Malone, CCIM
(207) 772-2422
joe@malonecb.com
www.malonecb.com