

Office Space For Lease

Governor's Place Executive Offices

33 Bloomfield Hills Parkway, Suite 260
Bloomfield Hills, MI 48304

5,443 Rentable Square Feet

- Classic Williamsburg architectural design
- Easy access to the Detroit Metropolitan freeway
- Beautifully landscaped
- Operative windows that provide fresh air
- Convenient and ample parking
- Customer oriented building owners and managers
- Located in the heart of prestigious Bloomfield Hills
- Close to Bloomfield Hills CC, Open Hunt Club
- Convenient to banks, hotels and gyms

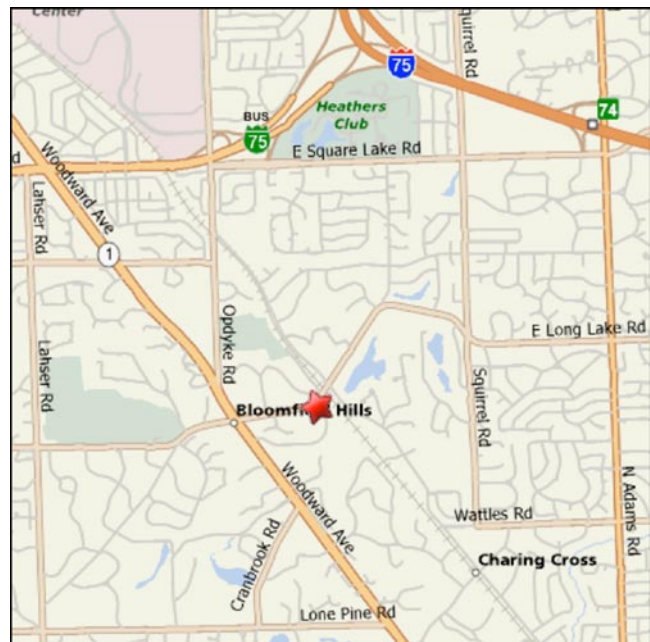
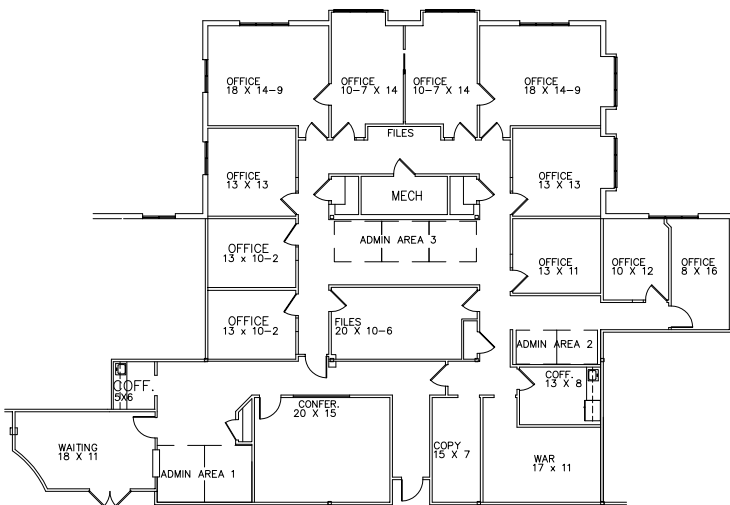

Governor's Place Executive Offices

Suite Size & Address:	5,443 Rentable Square Feet at 33 Bloomfield Hills Parkway, Suite 260
Load Factor:	Twelve (12%) percent
Availability:	For information, visit www.beachumroeser.com or call 248-647-7500
Rental Rate <small>(Modified Gross):</small>	\$25.00 per RSF
Escalation:	Three (3%) percent per annum
Tax & Operating:	Base Year
Term:	Five (5) year term
Utilities:	Gas and electric separately metered – paid by tenant
Communications:	DSL, T-1, Cable (Comcast)
Parking Ratio:	<i>General office:</i> 5 spaces per 1,000 u.s.f.

Unique Features:

- Classic Williamsburg architectural design
- Easy access to the Detroit Metropolitan freeway system
- Beautiful landscaping
- Operative windows that provide fresh air
- Convenient and ample parking
- Customer oriented building owners and managers

Quick Demographics - Oakland County, MI:

- Population (2005): 1,214,361
- Median household income (2005): \$64,022
- Median house value (2005): \$245,269
- Bloomfield Township median household income (2005): \$103,300
- Bloomfield Township median house/condo value in 2005: \$463,200

Contact:	Michelle A. Riley
Phone:	248-647-7500
Cell:	248-496-6504
Fax:	248-665-0006
E-Mail:	mriley@beachumroeser.com