

FOR LEASE > INDUSTRIAL SPACE



Willow Grove Industrial

1229 - 1253 N. MIDLAND BLVD. NAMPA, ID



Willow Grove Industrial > Industrial Space

Individual warehouses with a bathroom and small office, located one-half mile from Caldwell Boulevard, just off Midland. Surrounded by a mixture of office and retail buildings, plus residential development. Aggressive lease rates!

Property Profile

- > Available Space:
 - > Suite 1233 1,200 SF \$450 P/MO
 - > Suite 1235 1,200 SF \$475 P/MO
 - > Suite 1237/1239 2,400 SF \$799 P/MO
- > Project Size: Three Buildings, 15,600 total SF
- > CAM: \$.11 PSF / MO
- > Year Built: 2000
- > Individually metered
- > Shared parking
- > Clear Ceiling Height: 12' 6"
- > 10' x 10' roll-up doors



AGENT: LINCOLN HAGOOD
208 472 1667 | EXT. 855
NAMPA, ID
lincoln.hagood@colliers.com

COLLIERS INTERNATIONAL
5660 East Franklin Road
Suite 110
Nampa, ID 83687
www.colliers.com

Willow Grove Industrial > Floor Plan & Site Plan

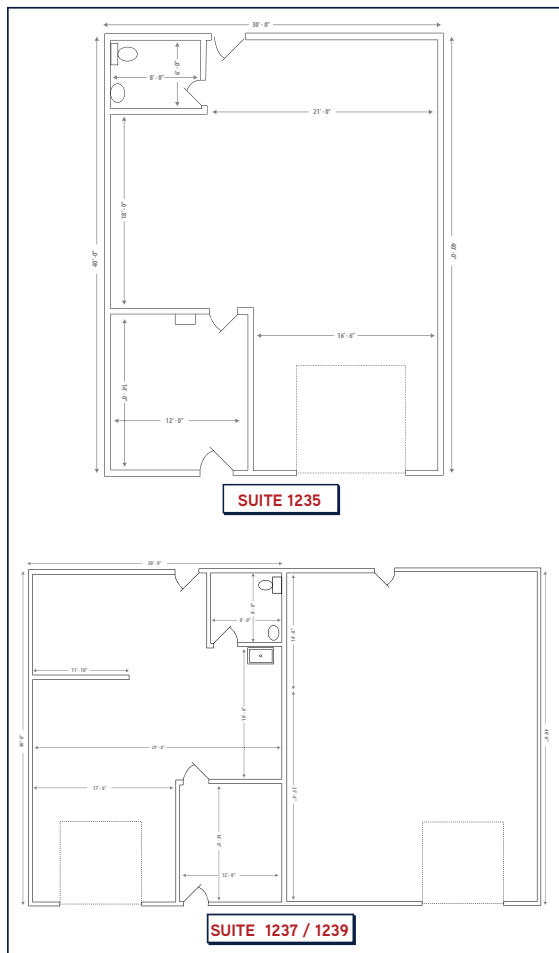
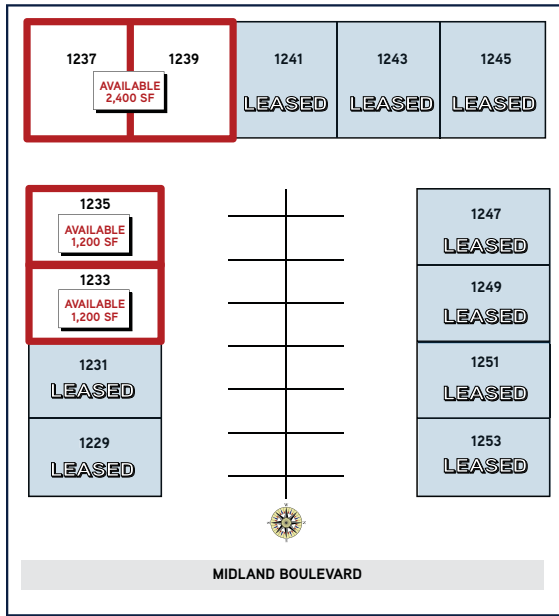

Contact Us

AGENT: LINCOLN HAGOOD
 208 472 1667 | EXT. 855
 NAMPA, ID
lincoln.hagood@colliers.com

COLLIERS INTERNATIONAL
 5660 East Franklin Road
 Suite 110
 Nampa, ID 83687
www.colliers.com

