

INDUSTRIAL SPACE
FOR LEASE1915 N. Elder St.

Nampa | Idaho

NEW
LISTING

PROPERTY PROFILE

- A 45,360± sq ft quality industrial / warehouse building well located off of the Nampa Franklin Rd. exit
- Corporate quality image offering amenities such as dock and grade level loading and automatic gated and secured yard
- Zoned Industrial
- **9,000± sq ft available**
 - Warehouse sq ft = 8,200± SF
 - Office sq ft = 800± SF
- (2) dock high doors
- (1) 16'x14' grade level door
- 200 amps, 3-phase power
- Fully sprinklered
- 25' clear height

LEASE RATE

- **\$0.39 NNN PSF**
- **\$0.10 PSF NNN expenses**



FOR MORE INFORMATION:

STEVE FOSTER

208-472-2834

steve.foster@colliersidaho.net

JAKE TUCKER

208-472-2842

jake.tucker@colliersidaho.net

INDUSTRIAL SPACE
FOR LEASE

1915 N. Elder St.

Nampa | Idaho

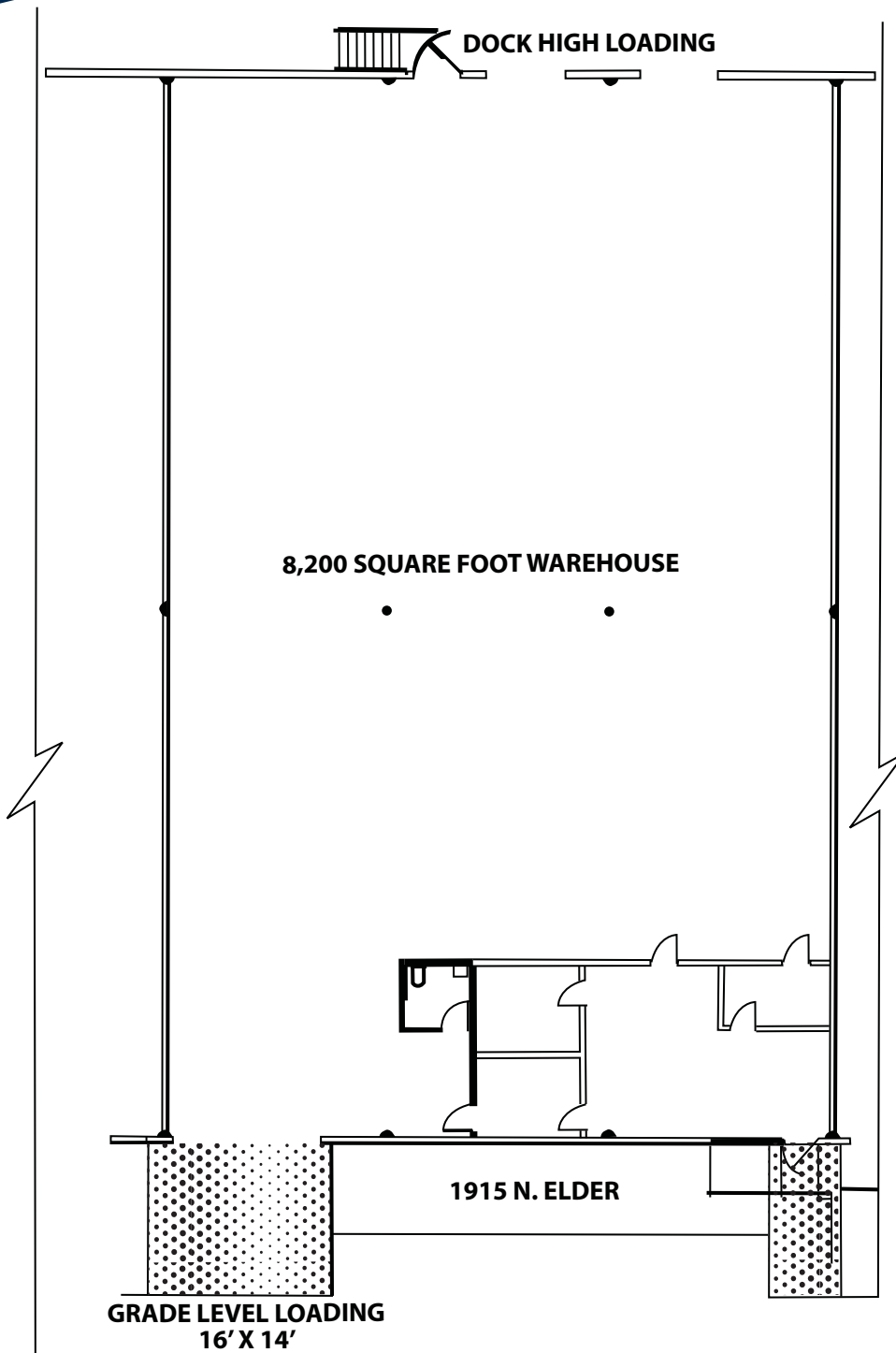

* LOCKBOX FRONT DOOR

FOR MORE INFORMATION:

STEVE FOSTER

208-472-2834

steve.foster@colliersidaho.net

JAKE TUCKER

208-472-2842

jake.tucker@colliersidaho.net

BOISE
755 W. Front St., Suite 300
Boise, Idaho 83702
208.345.9000

NAMPA
5660 E. Franklin Rd., Suite 110
Nampa, Idaho 83687
208.472.1660

COLLIERS
INTERNATIONAL