

FOR
LEASE

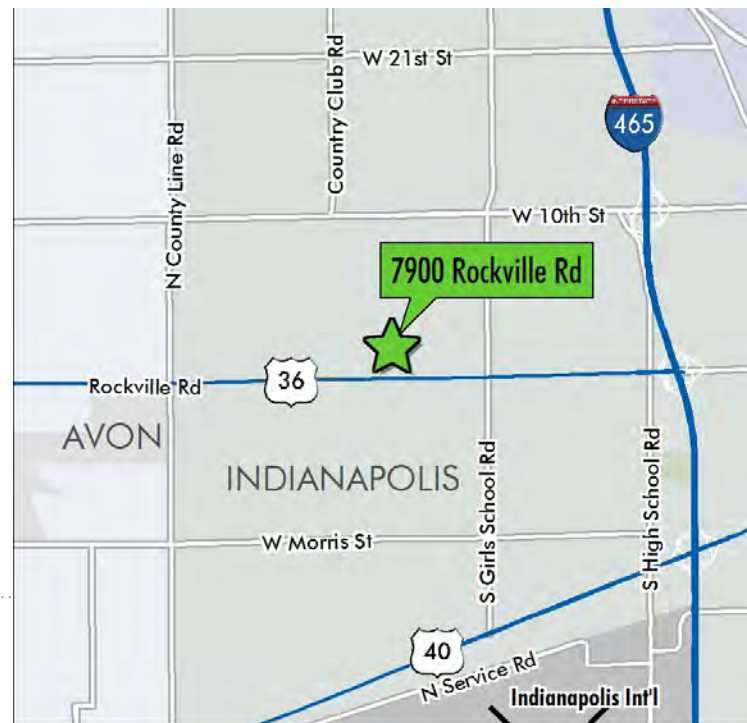

7900 ROCKVILLE ROAD
ROCKVILLE BUSINESS CENTER
INDIANAPOLIS :: IN



FOR MORE
INFORMATION
PLEASE
CONTACT

MARK WRITT

Senior Vice President
317.269.1029
mark.writt@cbre.com

CB Richard Ellis | 101 W. Washington Street | Suite 1000 E | Indianapolis, IN 46204 | www.cbreindy.com

©2009 CB Richard Ellis, Inc. The information above has been obtained from sources believed reliable. While we do not doubt its accuracy, we have not verified it and make no guarantee, warranty or representation about it. It is your responsibility to independently confirm its accuracy and completeness.



For additional information, please visit the website:
www.cbre.com/7900RockvilleRoad

NOW
AVAILABLE



7900 ROCKVILLE ROAD
INDIANAPOLIS, INDIANA
ROCKVILLE BUSINESS CENTER
MANUFACTURING :: DISTRIBUTION

FOR
LEASE

51,829 -
203,772 SQ. FT.

PROPERTY IS
DIVISIBLE INTO
MULTIPLE SIZE
WAREHOUSE UNITS

FOR MORE
INFORMATION
PLEASE
CONTACT:

MARK WRITT

Senior Vice President
317.269.1029
mark.writt@cbre.com



- :: EASY ACCESS TO I-465 AT ROCKVILLE ROAD EXIT
- :: LARGE AUTOMOBILE AND TRUCK TRAILER PARKING AREAS
- :: HEAVY POWER DISTRIBUTED THROUGHOUT THE FACILITY
- :: OUTSIDE STORAGE CAPABILITIES



FOR
LEASE



7900 ROCKVILLE ROAD
ROCKVILLE BUSINESS CENTER
INDIANAPOLIS :: IN

SPACE PLAN:

Conceptual Plan - spaces may be subdivided

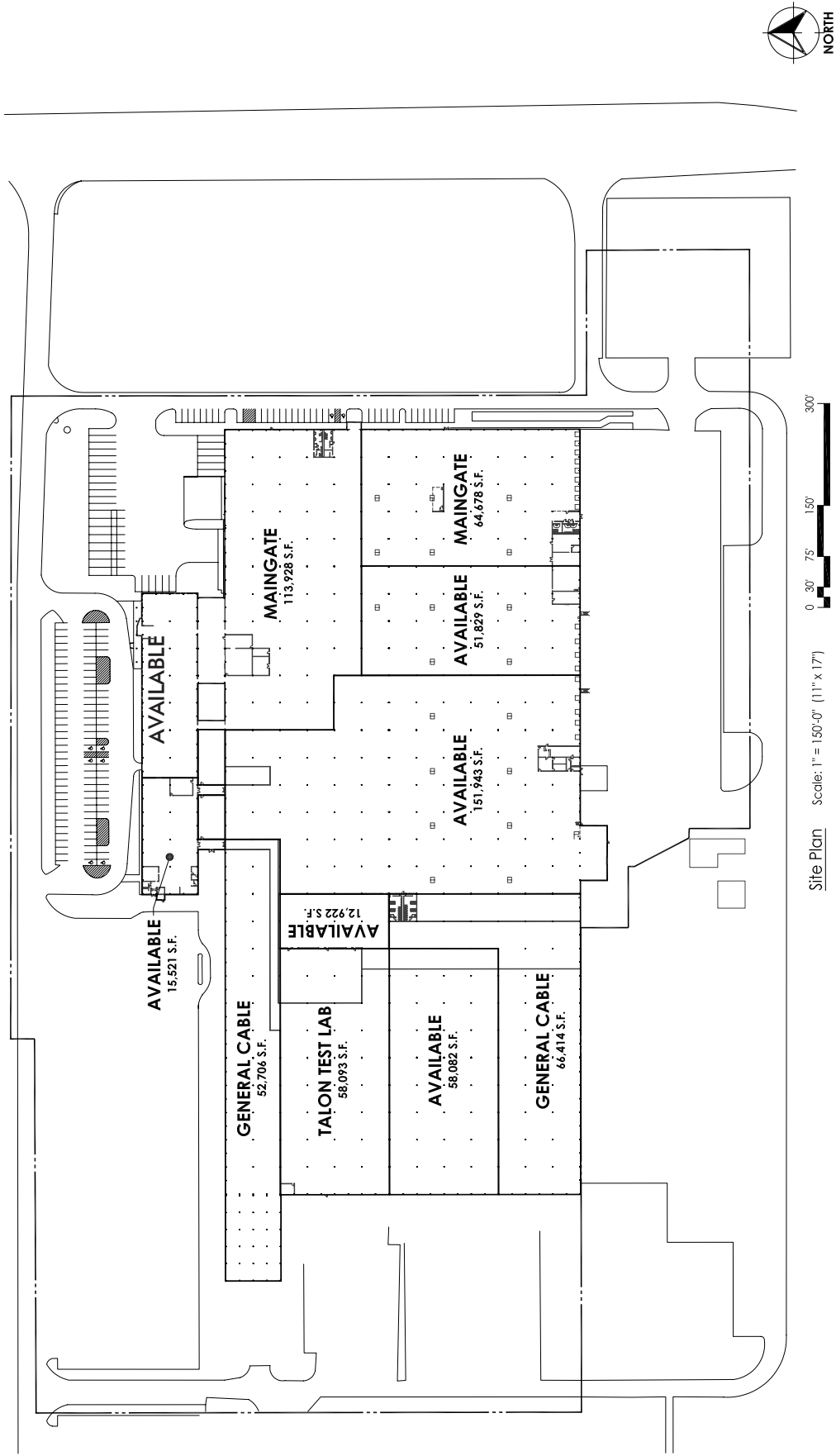

FOR
LEASE



7900 ROCKVILLE ROAD
ROCKVILLE BUSINESS CENTER
INDIANAPOLIS :: IN

FEATURES:

:: BUILDING SIZE:	617,212 SQ. FT.
:: AVAILABLE SPACE:	290,297 SQ. FT.
:: OFFICE SPACE:	15,521 SQ. FT.
:: CONSTRUCTION:	METAL & BRICK
:: CEILING HEIGHT:	18'6" CLEAR
:: COLUMN SPACING:	40' X 40'
:: DOCK DOORS:	(14) 9x10 DOCK DOORS W/LEVELERS & SEALS
:: DRIVE IN DOORS:	(2)10x10 DRIVE IN DOORS
:: PARKING:	100 AUTO SPACES & AVAILABLE TRAILER STORAGE SPACES
:: LIGHTING:	MERCURY VAPOR/FLUORESCENT
:: ELECTRICAL:	8000 A/277-480V/3P 4W
:: HEATING:	GAS FIRED UNIT
:: FIRE PROTECTION:	FULLY SPRINKLERED
:: POSSIBLE RAIL:	CONRAIL/CSX
:: ZONING:	I-4-S



METAL HALIDE LIGHTING



NEWLY PAINTED WHITE CEILING DECK